

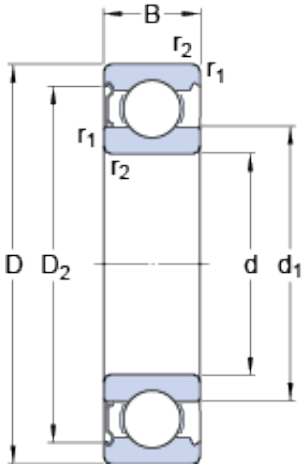

Huaxin Bearing Co., Ltd



45 mm x 85 mm x 19 mm SKF 6209-Z deep groove ball bearings

Bearing No. 6209-Z

6209-Z Bearing 2D drawings and 3D CAD models

Size	85x45x19 mm
Bore Diameter	85 mm
Outer Diameter	45 mm
Width	19 mm
d	45 mm
D	85 mm
B	19 mm
d ₁	57.6 mm
D ₂	75.19 mm
r _{1,2} - min.	1.1 mm
d _a - min.	52 mm
d _a - max.	57.5 mm
D _a - max.	78 mm
r _a - max.	1 mm
Basic dynamic load rating - C	35.1 kN
Basic static load rating - C ₀	21.6 kN
Fatigue load limit - P _u	0.915 kN
Reference speed	17000 r/min
Limiting speed	11000 r/min
Calculation factor - k _r	0.025
Calculation factor - f ₀	14.2
Category	Single Row Ball Bearings
Inventory	0.0
Manufacturer Name	SKF



Huaxin Bearing Co., Ltd

Minimum Buy Quantity	N/A
Weight / Kilogram	0.425
Product Group	B00308
Enclosure	1 Metal Shield
Precision Class	ABEC 1 ISO P0
Maximum Capacity / Filling Slot	No
Rolling Element	Ball Bearing
Snap Ring	No
Internal Special Features	No
Cage Material	Steel
Internal Clearance	C0-Medium
Inch - Metric	Metric
Long Description	45MM Bore; 85MM Outside Diameter; 19MM Outer Race Diameter; 1 Metal Shield; Ball Bearing; ABEC 1 ISO P0; No Filling Slot; No Snap Ring; No Internal Special Features
Category	Single Row Ball Bearing
UNSPSC	31171504
Harmonized Tariff Code	8482.10.50.68
Noun	Bearing
Keyword String	Ball
Manufacturer URL	http://www.skf.com
Manufacturer Item Number	6209-Z
Weight / LBS	0.94
Outer Race Width	0.748 Inch 19 Millimeter
Bore	1.772 Inch 45 Millimeter
Outside Diameter	3.346 Inch 85 Millimeter
d_1	57.6 mm
D_2	75.19 mm
$r_{1,2}$ min.	1.1 mm



Huaxin Bearing Co., Ltd

d_a min.	52 mm
d_a max.	57.5 mm
D_a max.	78 mm
r_a max.	1 mm
Basic dynamic load rating C	35.1 kN
Basic static load rating C_0	21.6 kN
Fatigue load limit P_u	0.915 kN
Calculation factor k_r	0.025
Calculation factor f_0	14.2
Mass bearing	0.42 kg